

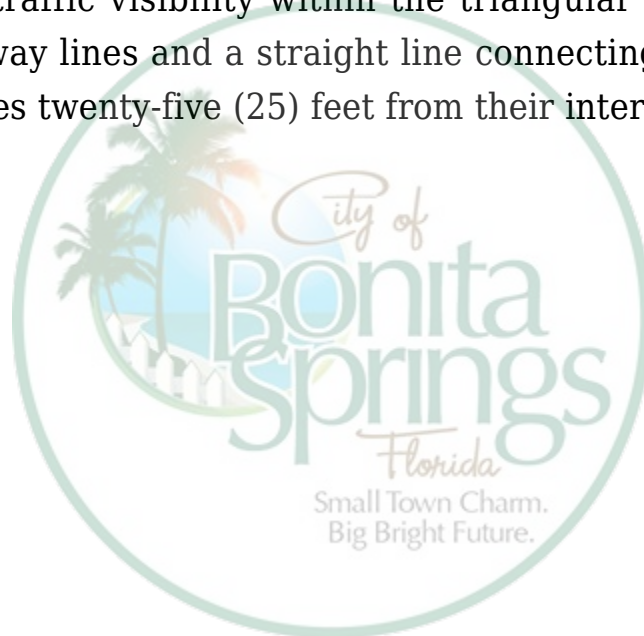

Visibility Triangle

[Go Back](#)

Corner lots. On a corner lot, no obstruction shall be planted or erected which materially obstructs traffic visibility within the triangular space bounded by two intersecting right-of-way lines and a straight line connecting the two points on the street right-of-way lines twenty-five (25) feet from their intersection (see illustration below).



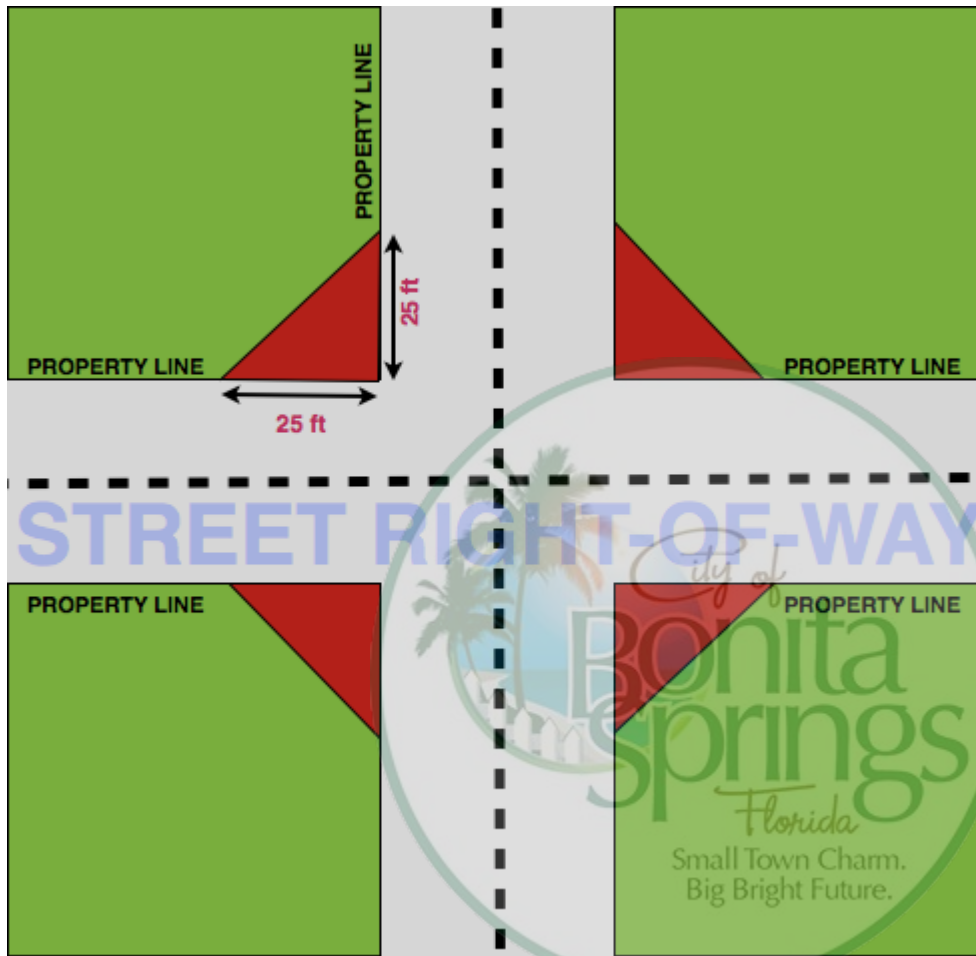

No structural and planting masses shall be permitted between three (3) feet and ten (10) feet above the average grade of each street (see illustration below).

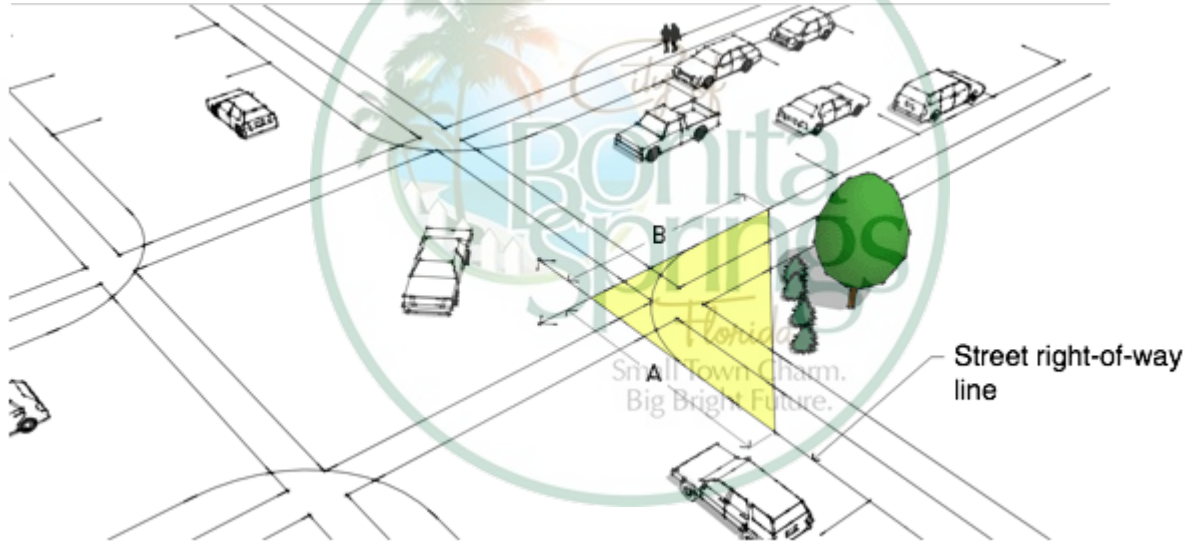
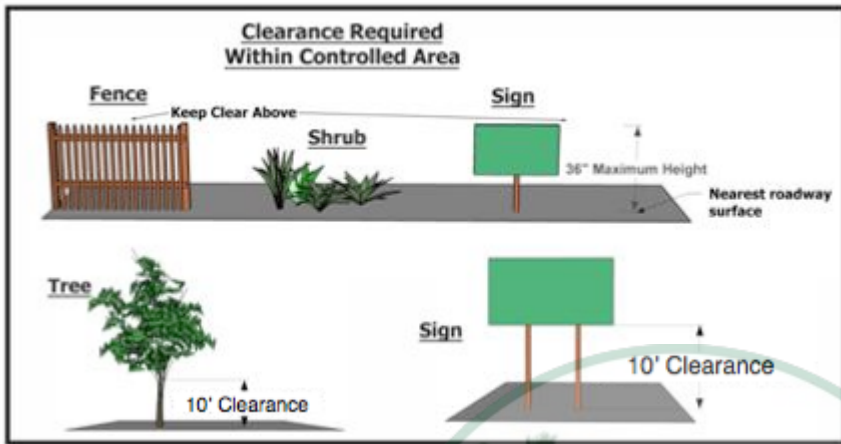

Driveways and parking lot entrances. At intersections of driveways or parking lot entrances with a street right-of-way or easement, no obstruction shall be planted or erected which materially obstructs the drivers view of approaching traffic and/or pedestrians.

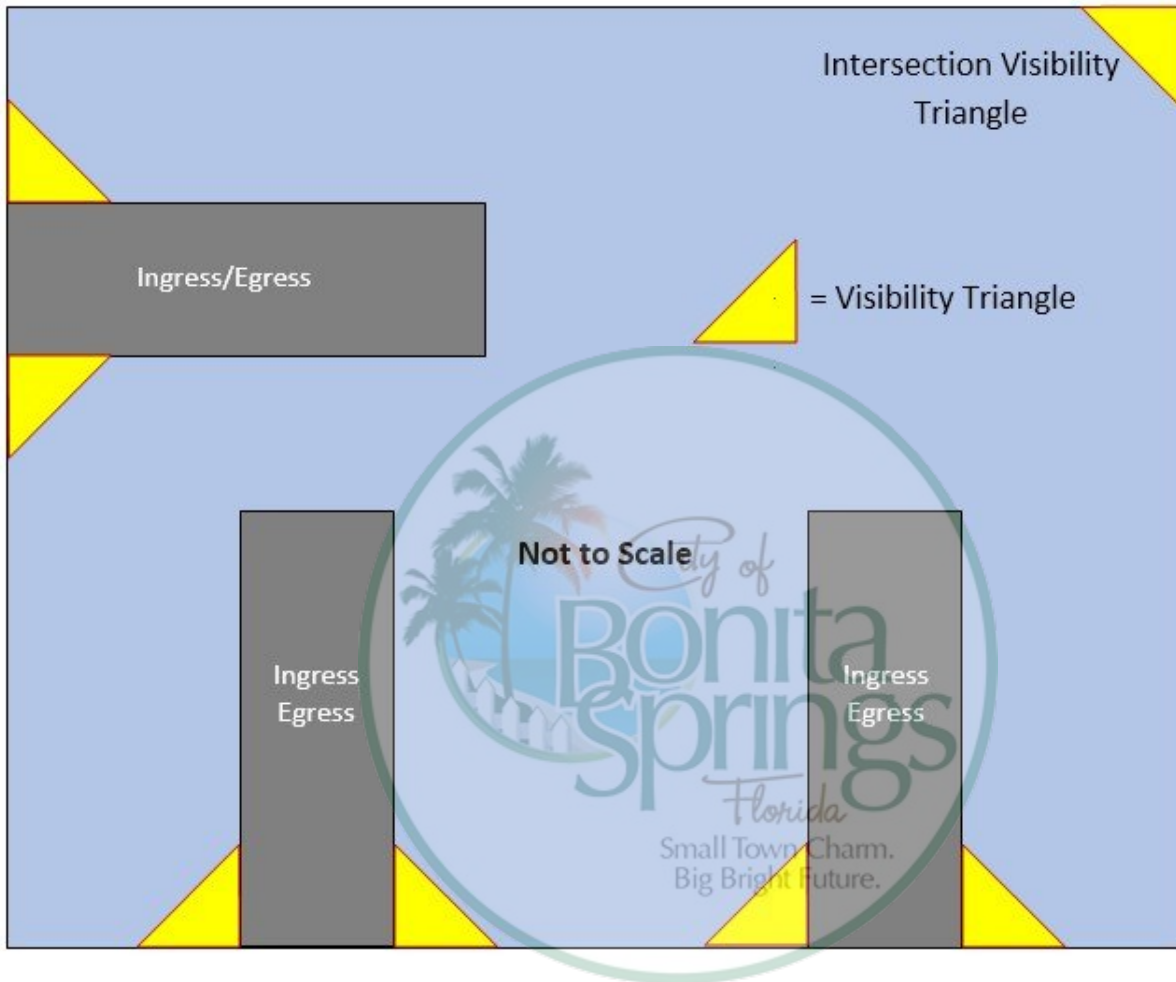

6-71 (a) Visibility triangle. No sign shall be erected which would impair visibility at a street intersection or driveway entrance. Within the area formed by the right-of-way lines of intersecting streets or streets and driveways, and a straight line connecting points on such right-of-way lines at a distance of 25 feet from their point of intersection, such connecting lines extending beyond the points to the curved lines, there shall be a cleared space with no obstructions between the height of three feet and the height of ten feet above the average grade of each street as measured at the centerline thereof



If you have additional questions, please dial (239) 444-6150 and ask to speak with our planner-on-call who will be happy to assist you.

